



## Haute Route & Haute Route MIPS Twiceme Helmet

EN 12492: 2012  
EN 1077:2007 Class B  
EN1078:2012 + A1:2012  
PPE Regulation (EU) 2016/425

SGS Fimko Oy,  
Takomotie 8,  
FI-00380 Helsinki,  
Finland

Notified body number 0598



Helmet for

CE EN 1077 class B Skiing  
Class A and class B helmets are for alpine skiers, snowboarders and similar groups. Class A helmets offer comparatively more protection. Class B helmets may offer greater ventilation and better hearing, but protect a smaller area of the head and give a lesser degree of protection from penetration.

CE EN 1078 Biking, Skateboard & Roller skates

CE EN 12492 Mountaineering & Climbing

**Head Office**  
Mammut Sports Group AG  
Birren 5  
5703 Seon  
Switzerland

**Europe**  
Mammut Sports Group GmbH  
Mammut-Basecamp 1  
87787 Wolfertschwenden  
Germany

mammut.com/support/contact

MAMMUT

Haute Route & Haute Route MIPS Twiceme Helmet User Manual



MAMMUT

## Haute Route & Haute Route MIPS Twiceme Helmet User Manual

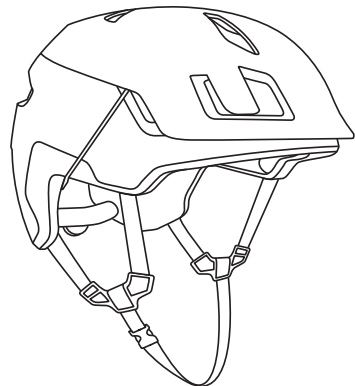

SWISS DESIGN • SINCE 1882



## Haute Route & Haute Route MIPS Twiceme Helmet

Sizes



S 51–55 cm  
20.0–21.6 in  
M 55–59 cm  
21.6–23.2 in  
L 59–63 cm  
23.2–24.8 in

### Warning

Please read these guidelines carefully and follow them strictly before using the product. It can save your life.

The warning symbols below represent different levels of threat and are used to make this easily recognizable.

The latest version of the user manual can be found on mammut.com. The last digit of the packaging numbers will show you which version you have.

### Warning symbols



#### Danger of death

Failure to comply with any of these warnings may result in death or serious personal injury



#### High risk

High risk of accident or injury



#### Important information

Important information about how your product works or performs



Check latest version user manual



Other languages on mammut.com

## 3 Terminology

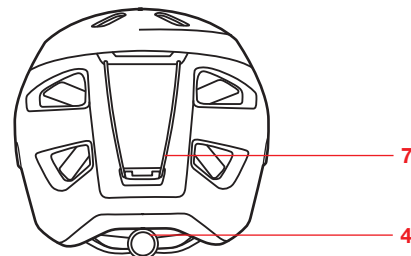
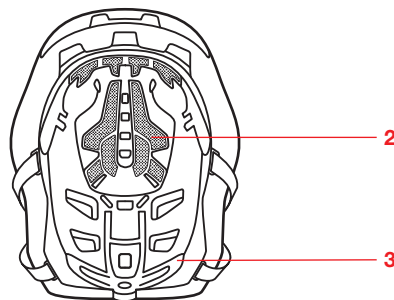
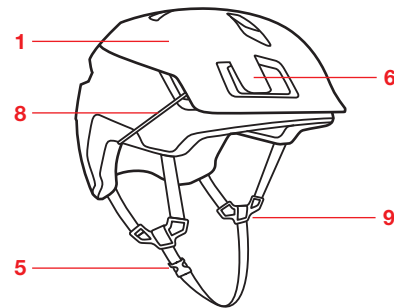

## 4 Fitting

### 4.1 Open

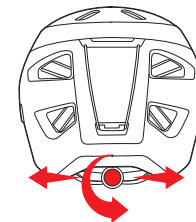

### 4.2 Tighten

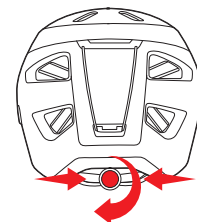

### 4.3 Adjust height

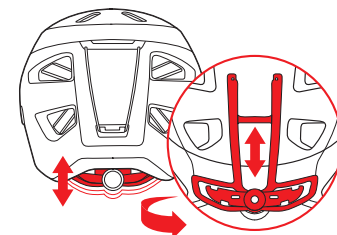

### 4.4 Check fit

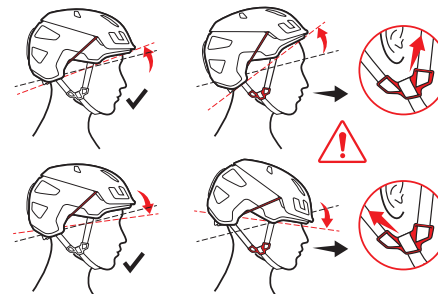

## 4 Fitting

### 4.5 Closing

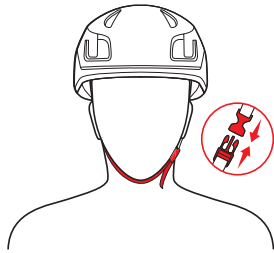

### 4.6 Check the length of the chin strap

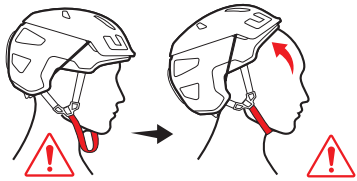

### 4.7 Select the right size

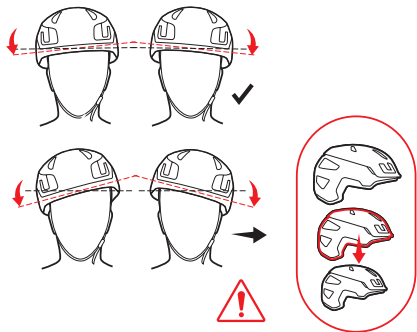

## 5 Accessories

### 5.1 Head lamp fixture

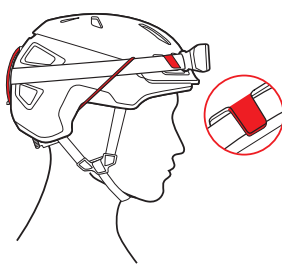

### 5.2 Goggle fixture

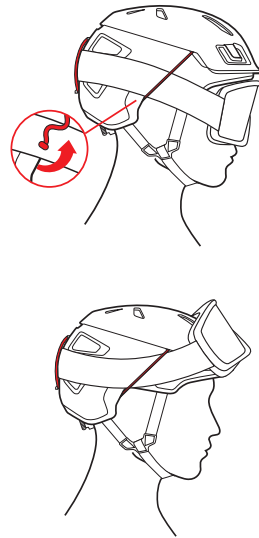

## 6 Inspection

### 6.1

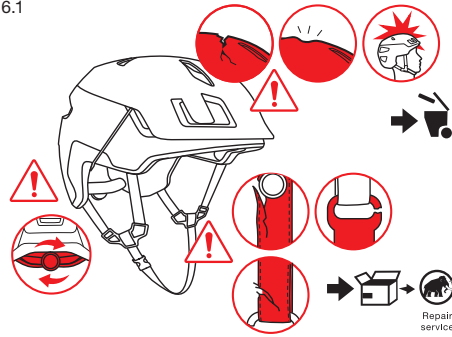

### 6.2



## 8 Storage & Transport



## 9 Cleaning



## 10 Drying

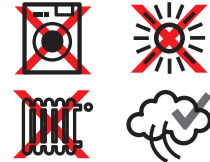

## 11 Repair and modifications

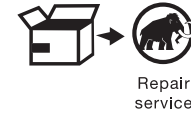

## 12 Declaration of conformity



<https://ppe.mammut.com>

## 13 Explanation of marking

### 13.1 Sticker on the back of helmet

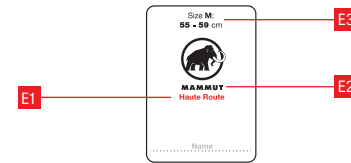

### 13.2 Sticker on the side of the helmet

